



Series 235 Card Lok

RECOMMENDED GAP WIDTH

PCB + 8.00 (.315)

RECOMMENDED TORQUE

68 N-cm (6 in-lbs)

WEIGHT

1.34 g/cm (.120 oz/in)

MATERIALS AND FINISH

WEDGES

Material:
Aluminum Alloy 6061-T6 per per
ASTM-B221 or AMS-QQ-A-200/8

Finish:
See finish table on opposite
page

SCREW

.09-in. or 2.5-mm hex. socket
head cap screw, depending
on mounting configuration

Material:
Stainless steel per ASTM-
A582

Finish:
Passivated per AMS2700

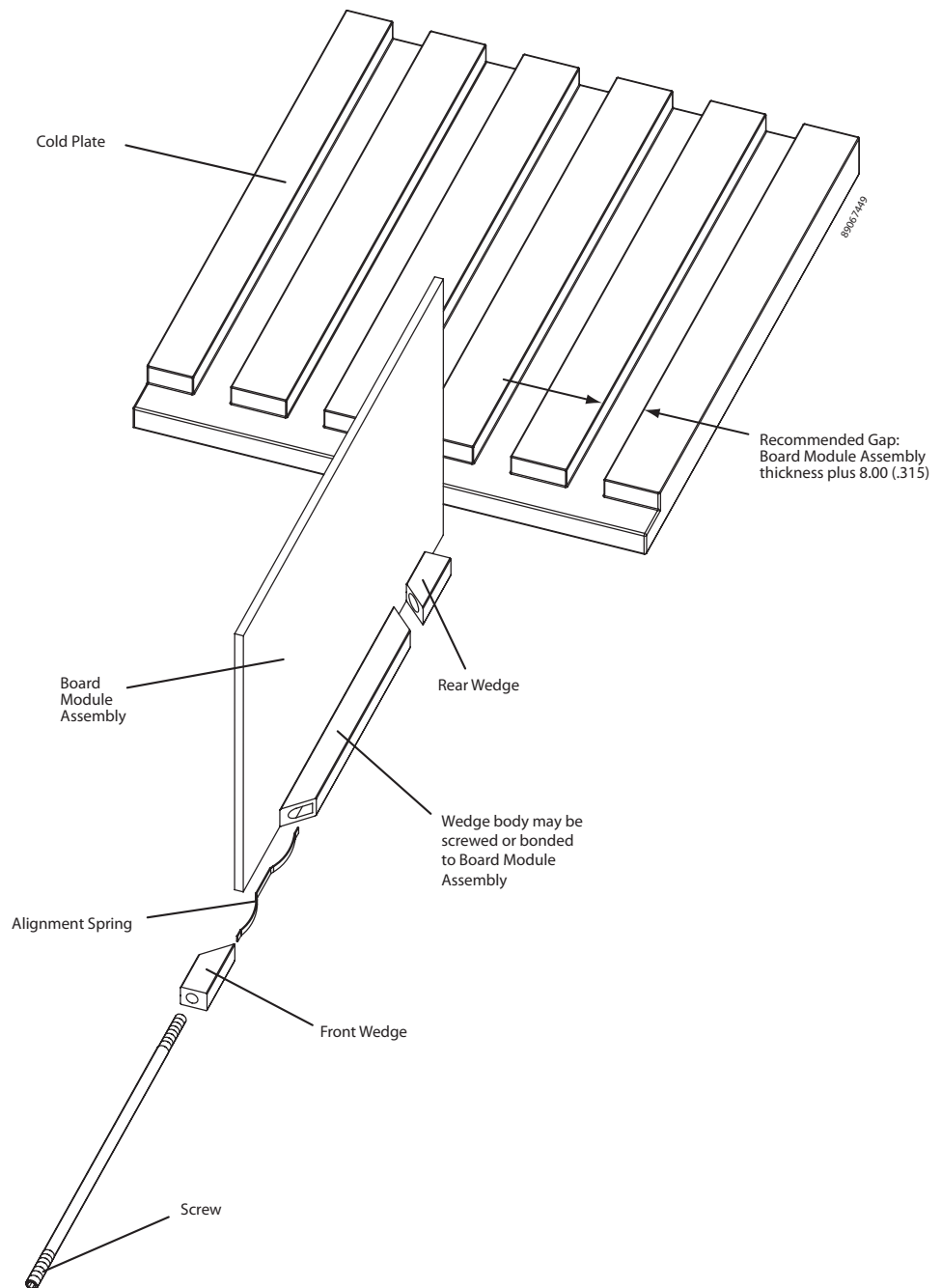

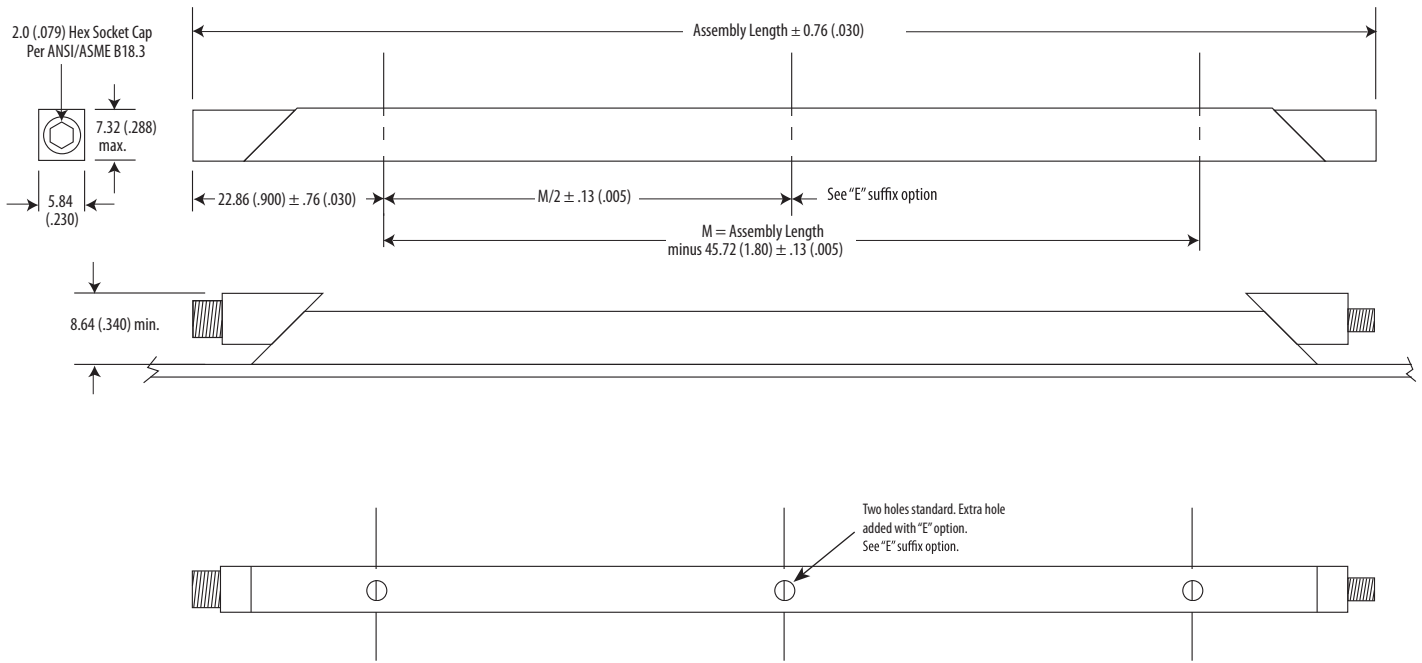

Units: mm (in.)
 Unless otherwise specified:
 .xx ± .25, .x ± .5
 (.xxx ± .010, .xx ± .02)
 Note: Each piece has a tolerance of ± .010

Part Number Code
Series 235 Card-Lok Three Piece

Z S A 235 - 4.80 E TM2.5 P

Prefix options
 Slotted Drive _____ S
 2mm Hex Drive _____ [blank]

Finish options
 Black Anodize _____ A
 or choose from Finish Table

Assembly length in inches. Standard lengths range from 71.12 (2.80), 96.52 (3.80) and 121.9 (4.80). _____ length.xx
 Other lengths available upon request

Additional Center Mounting Hole _____ E
 None _____ [blank]

Mounting Options - M2.5 tapped hole _____ TM2.5
 or choose from Mounting Option Table _____ see table

Locking Insert Option _____ P
 None _____ [blank]

FINISH TABLE	
Code Letter	Finish
[blank]	Chemical Film per Mil-DTL-5541 Class 1A, Type 1, Gold
"R"	Chemical Film per Mil-DTL-5541 Class 3, Type II, Clear
"A"	Black Anodize per Mil-A-8625 Type II, Class 2
"HA"	Hard Black Anodize per Mil-A-8625 Type III, Class 2
"EN"	Electroless Nickel per Mil-C-26074 Class 4, Grade B, Bright

MOUNTING METHOD TABLE	
Code Letter	Method
[blank]	No mounting holes
"T0"	0-80 tapped hole
"T2"	2-56 tapped hole
"TM2"	M2 x 0.40 tapped hole
"TM2.5"	M2.5 x 0.45 tapped hole

Part Number Code Example:

A235-2.80ETM2.5

Series 235 Card-Lok three piece, black anodized, 71.12 (2.80) assembly length, with three M2.5 tapped mounting holes.