

**Oberteil  
Top-Part**

**Platine Oberteil  
P C B Top Part**

**Unterteil  
Bottom-Part**

**Platine Unterteil  
P C B Bottom Part**

**Folientastatur  
membrane keyboard**

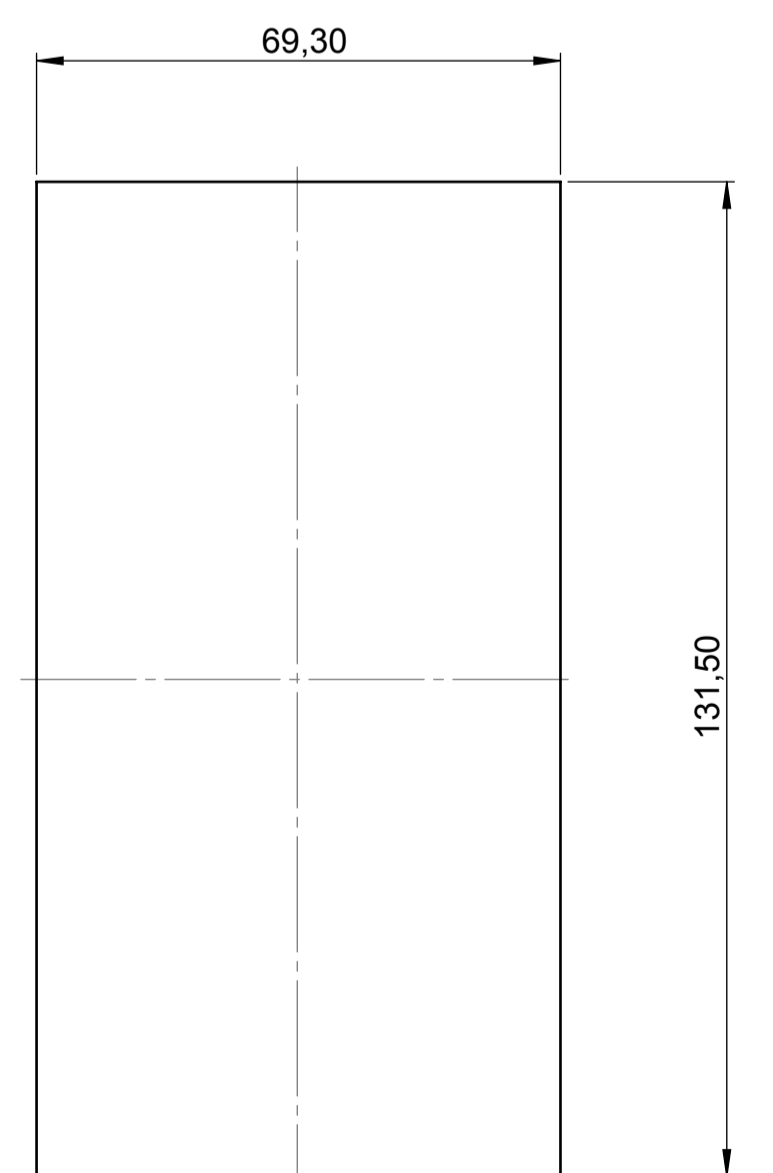
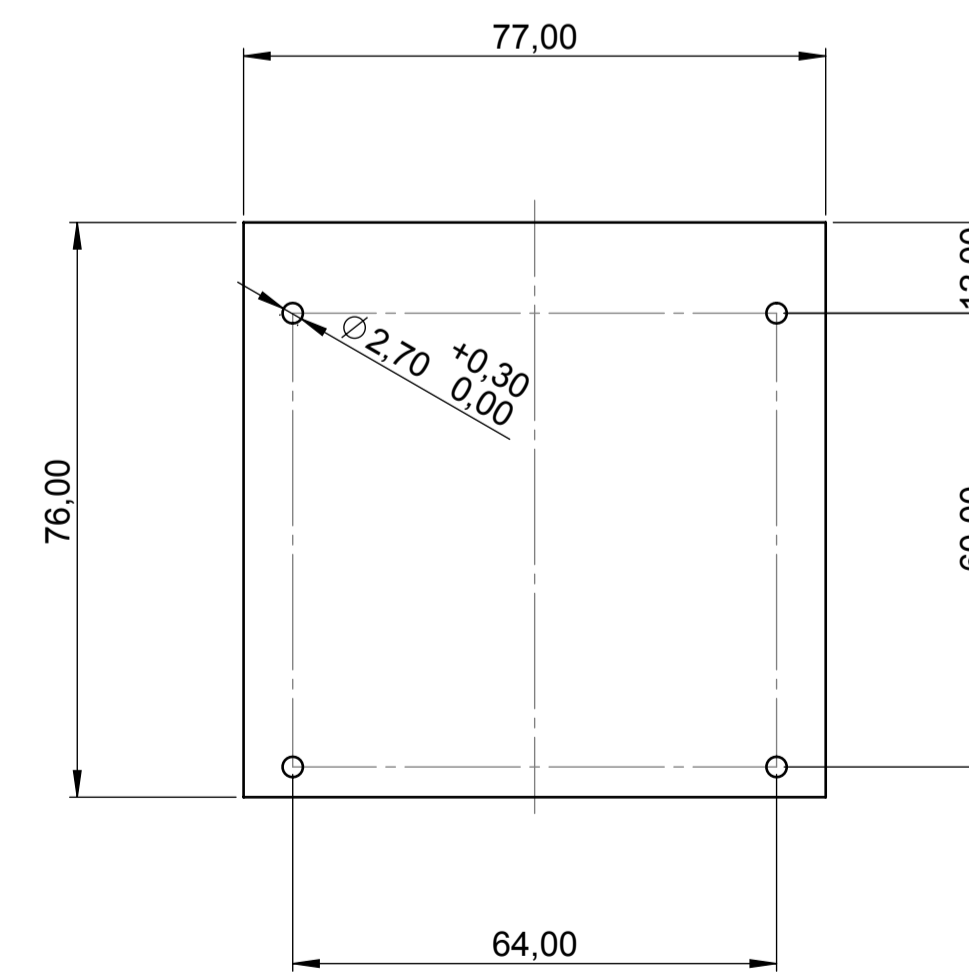
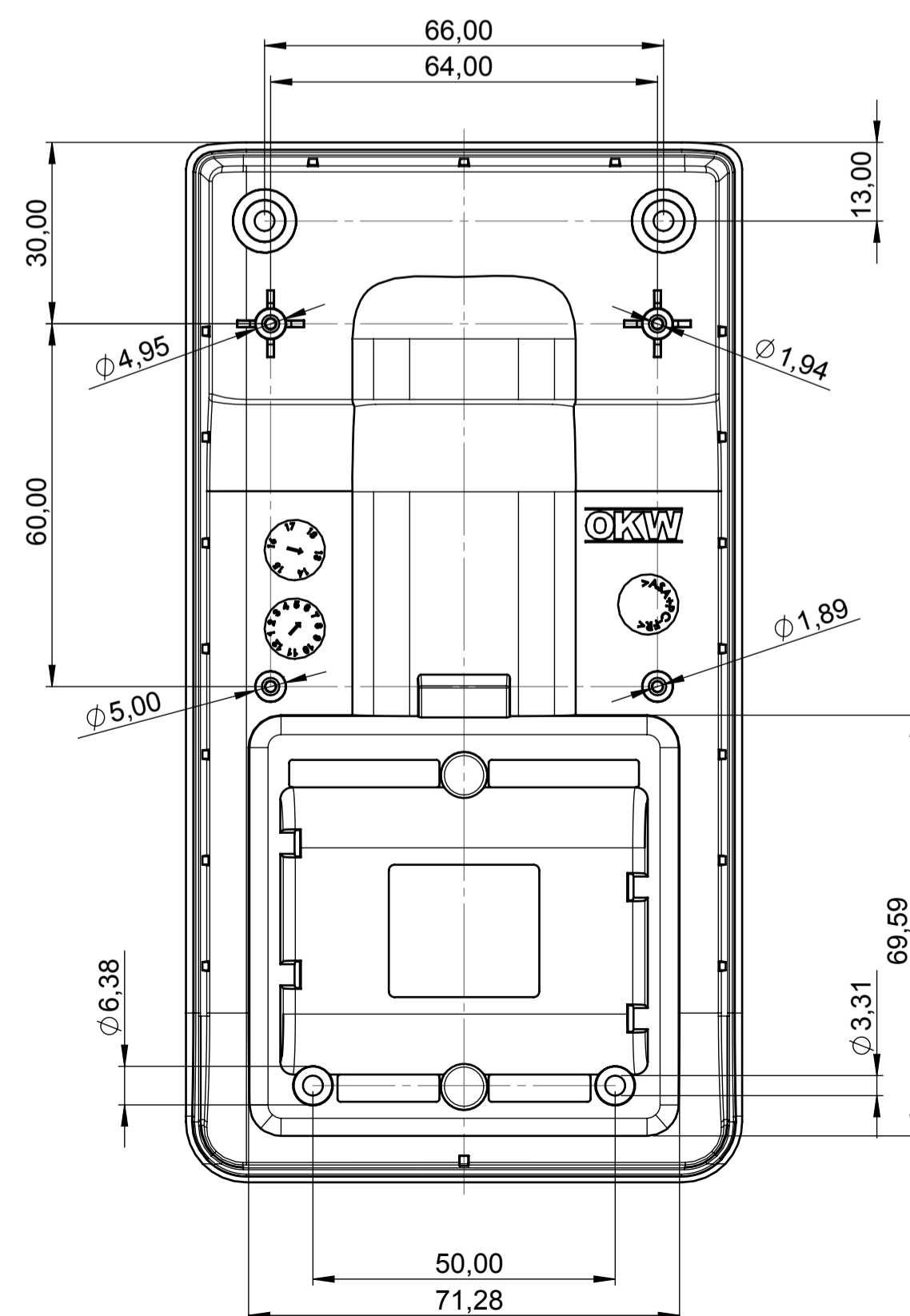
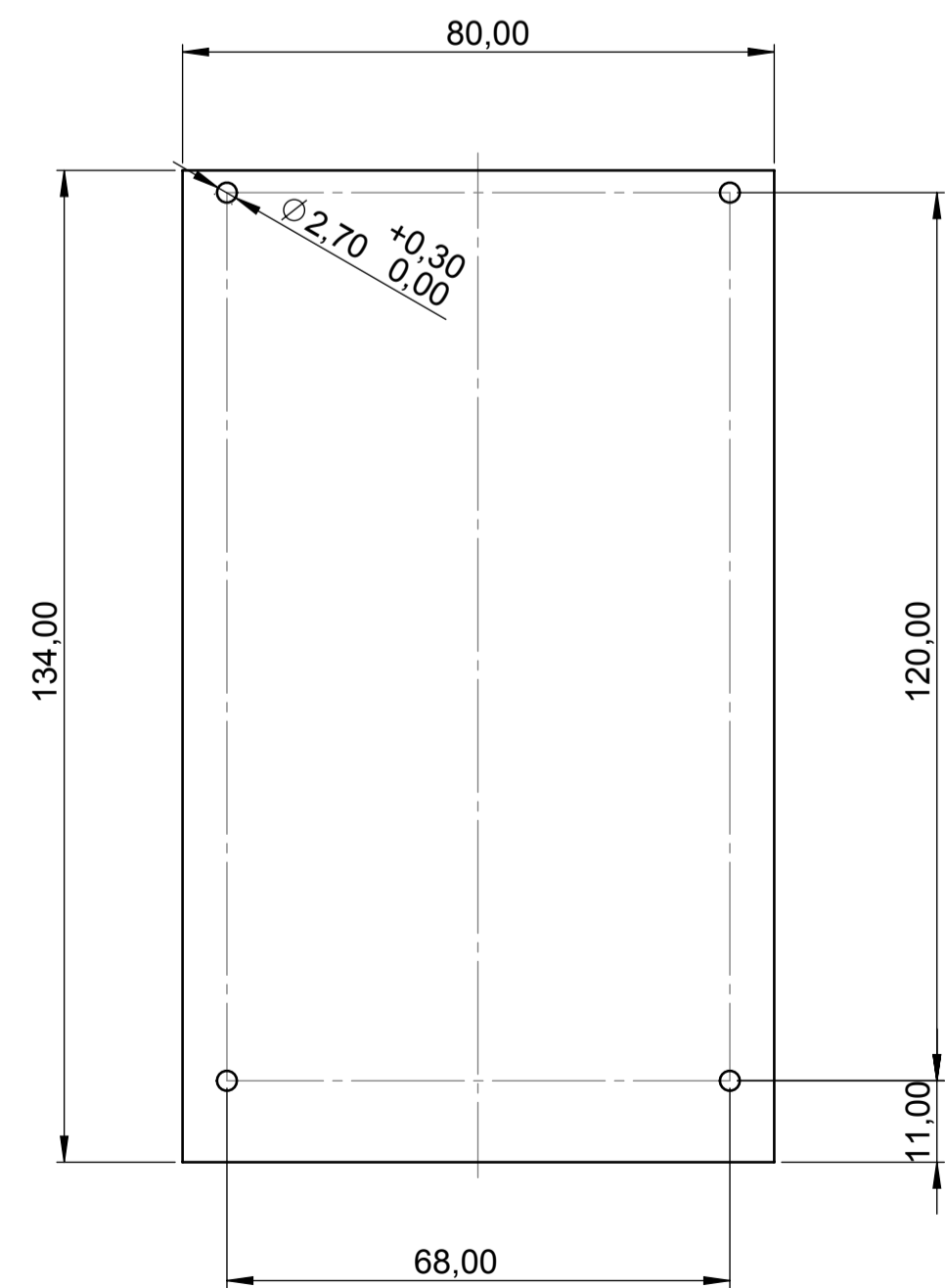
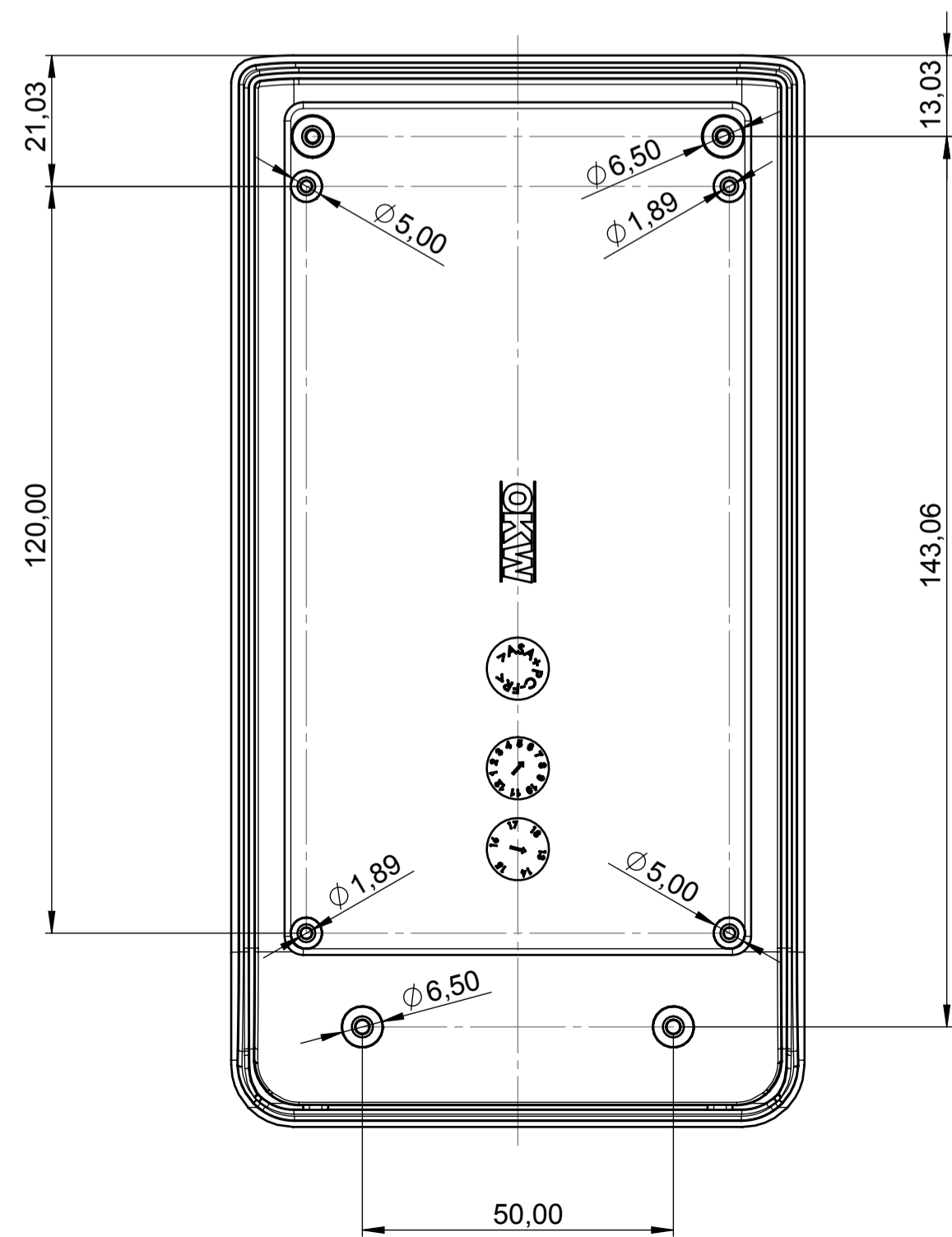

Erst. am: 19.03.2014  
 Erst. von: O. Herrlich  
 Freig. am: 15.05.2014  
 Freig. von: O. Herrlich  
 Revision: 01

Toleranzen:  
 DIN 16901 T130  
 Volumen:  
 Zeichnungsart:  
 KUNDE:

Status:  
 SERIENFREIGABE  
 Zeichnungsart:  
 KUNDE:  
 DIN 6 Teil 2

This document contains proprietary information of OKW Gehäusesysteme GmbH and is rendered subject to the conditions that the information be retained in confidence and not be reproduced or copied and not be used or incorporated in any product.

**OKW**  
**GEHÄUSE**  
**SYSTEME**

**DATEC-COMPACT M**  
**Gehäuse mit Batteriefach**  
**A900620\***

M 1:1  
 Dateiname: 00015414